

SHOTCRETE OR CAST-IN-PLACE
CONCRETE WALL

60 DRY MILS LIQUID BOOT®
(100 DRY MILS IF SHOTCRETE)

LIQUID BOOT® BaseFabric T-60

LIQUID BOOT® UltraShield G-800

WOOD LAGGING

SOLDIER PILE

NATURAL EARTH

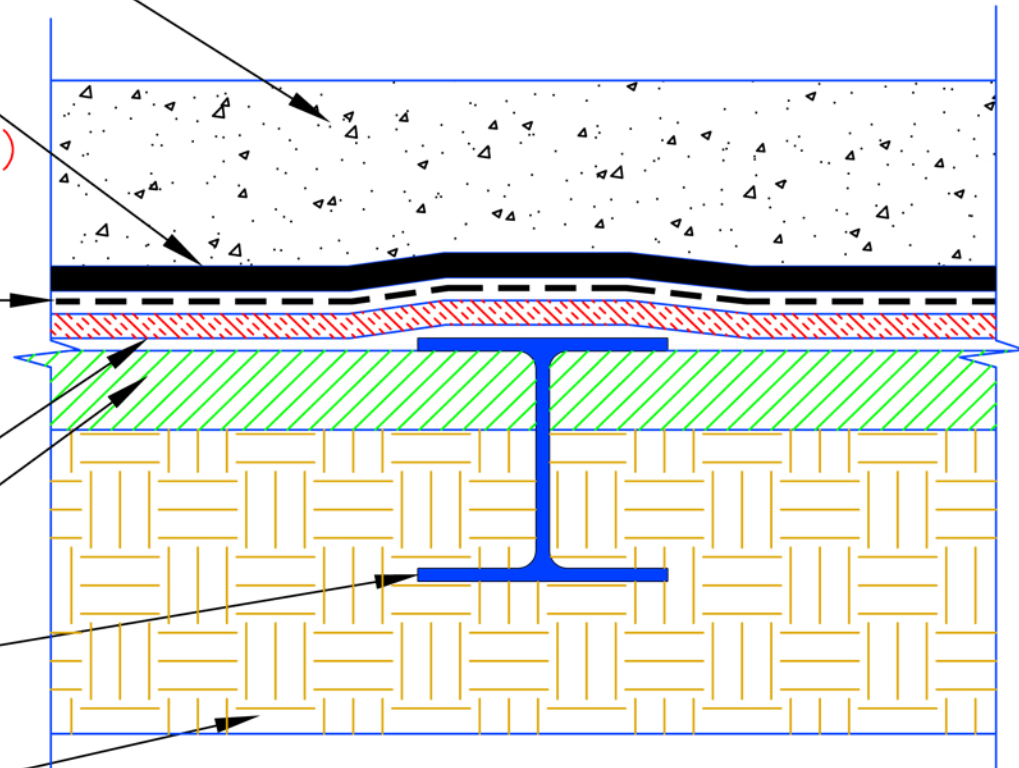

GAS VAPOR BARRIER ZERO LOT LINE WITH LAGGING

© 2009 CETCO Remediation Technologies

NOT TO SCALE

G1.1